

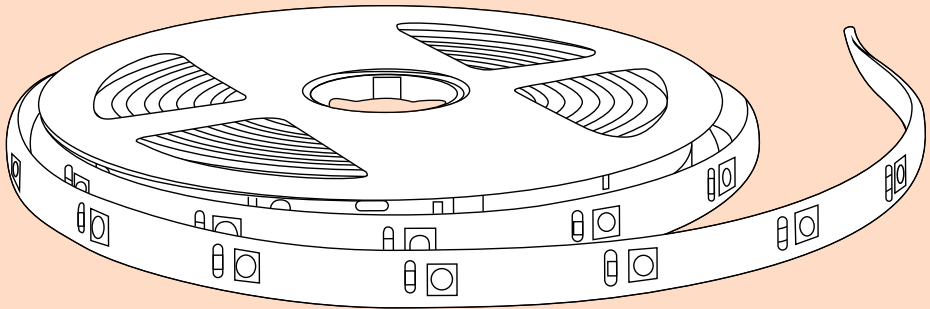

**LEGATE**  
Smart home

# SMART LED LIGHT STRIP

Manual Guide



Legate Smart Lighting



# Let's Get Started.

---

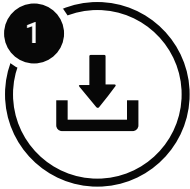

## Install the app

Download the **Legate Smart Home** app from Google Play or the App Store on a compatible phone or tablet.



## Register and login

Register on the app by using your contact number or Email address.



## Connect to wifi

Make sure that your mobile phone and smart device are connected to 2.4 GHz wifi network.

\*note: The distance between the phone and smart device should not be greater than 4meters while pairing both devices. If the signal is week you'll need a wifi booster. (Recommended Wifi Booster Version: **TP LINK TL-WA855RE**)

**Legate Smart LED Light Strip  
to Legate Smart Home App**

## Getting the Smart Device Ready

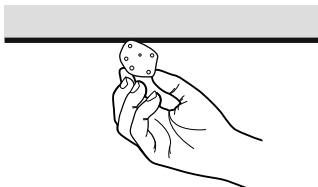

1

Clean the installation surface.

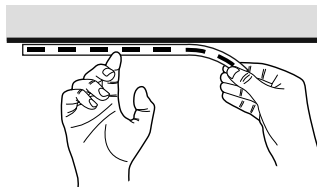

2

Stick the Smart LED Light on the installation surface.

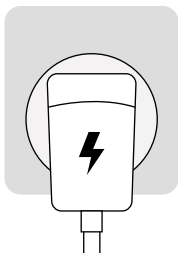

3

Plug the **Power Adapter** into the socket.

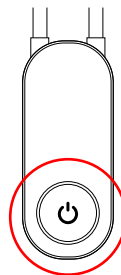

4

Press and hold the “**⏻**” button until the LED Light blinks.

## Add Smart Device

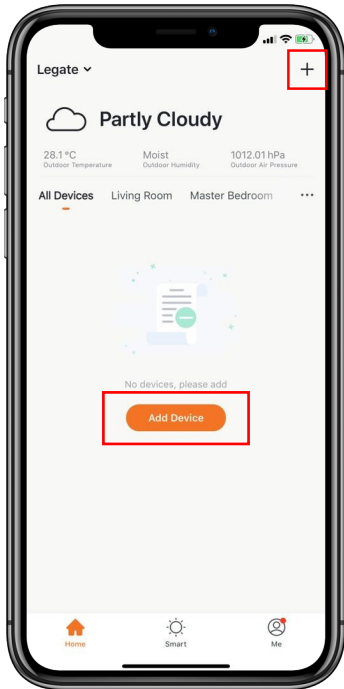

5

Open Legate Smart Home app,  
Click “+” or **Add Device**.

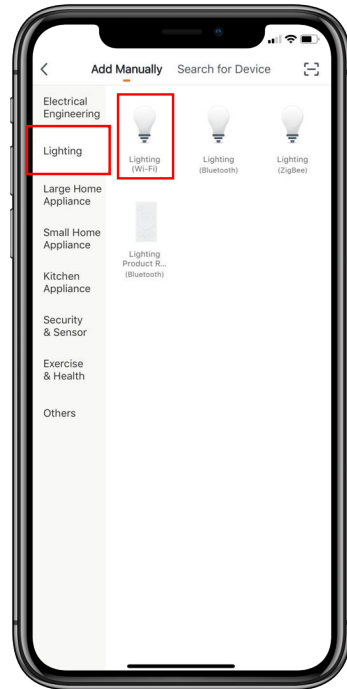

6

Under “**Lighting**” tab  
Click “**Lighting (Wi-Fi)**”.

## Network Configuration

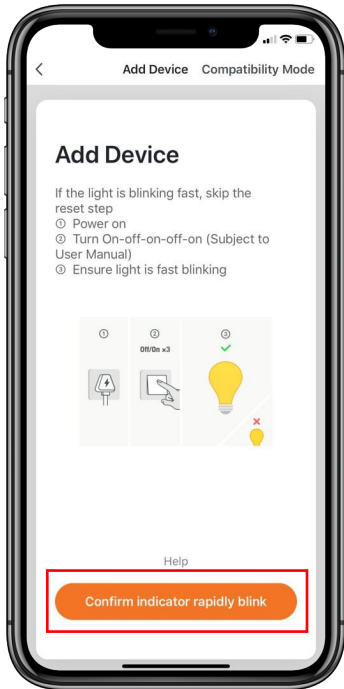

7

Click **“Confirm indicator rapidly blink”** button.

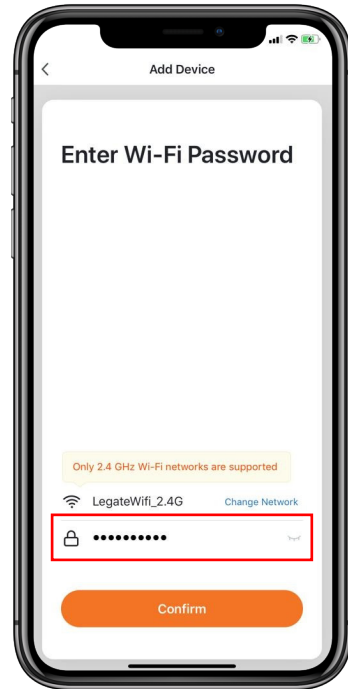

8

Enter your **Wifi Password**. Then click **“Confirm”** button.  
(note: Only 2.4 GHz Wifi network are supported)

## Network Configuration

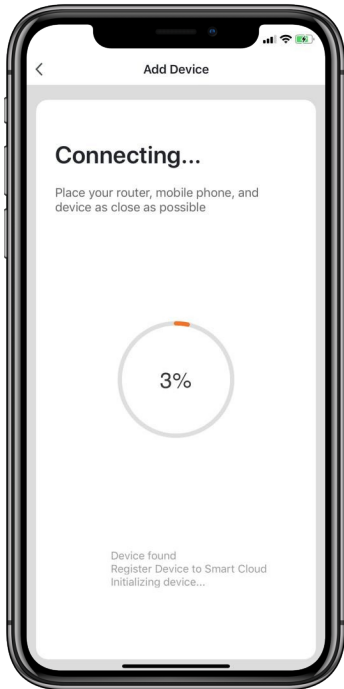

9

Wait for the Smart Device connects to the app.

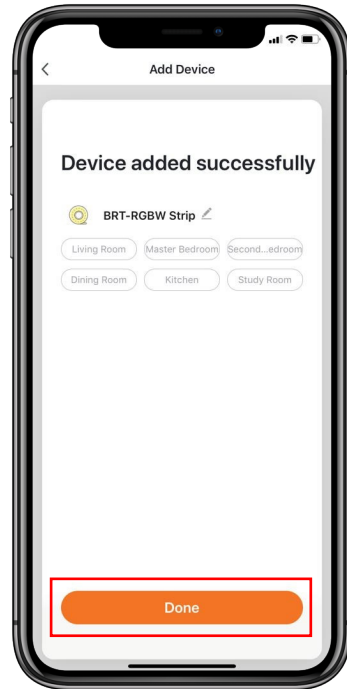

10

Click **“Done”** button when the Smart Device is successfully added.  
(note: You can change the device’s name)

# **Legate Smart LED Light Strip Features**



## Main Function



Adjust the Smart LED Light Strip's **Brightness**.



**Change the Colour** of the Smart LED Light Strip.

## Main Function

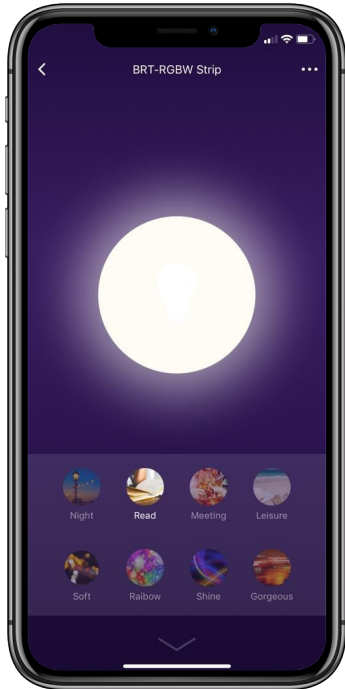

Set the **Scene/Mood** of the Smart LED Light Strip.

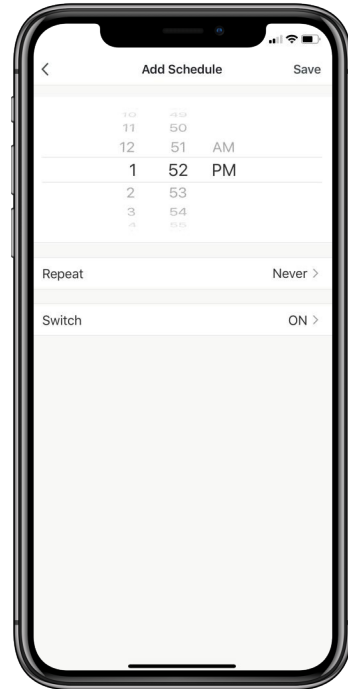

Able to set **Schedule** to ON/OFF the LED Light Strip.

# Push Notification

Enable to turn off the notification.

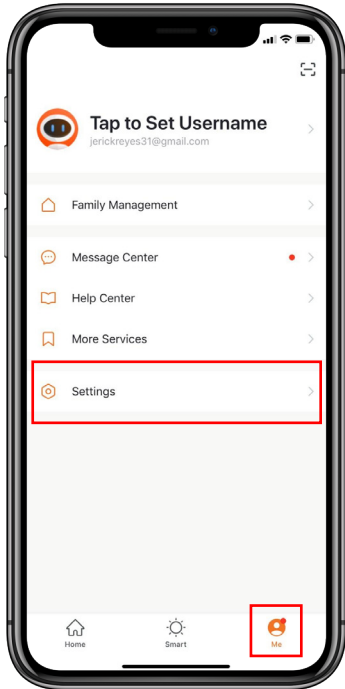

1

Click **"Me"** button on Legate Smart Home app. Then click **"Settings"**.

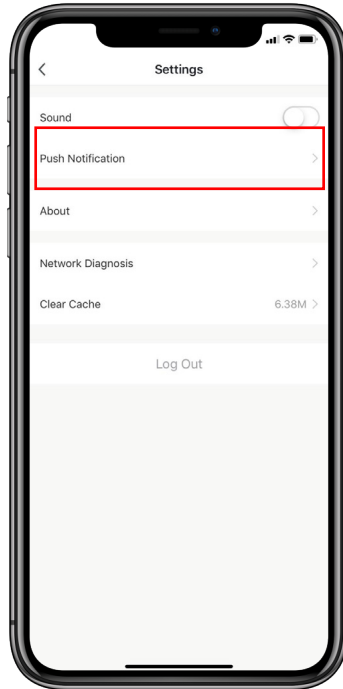

2

Click **"Push Notification"** tab.

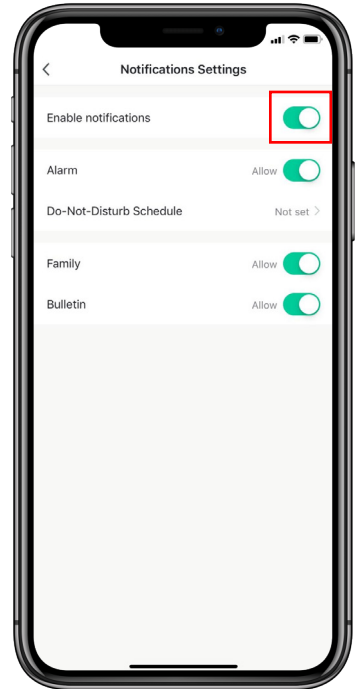

3

Can turn on or turn off the **"Enable notification"**

## Remove Device from Legate Smart Home app

The device will restore to default settings.



1

Click "... " button on upper right corner of Smart Camera main page.

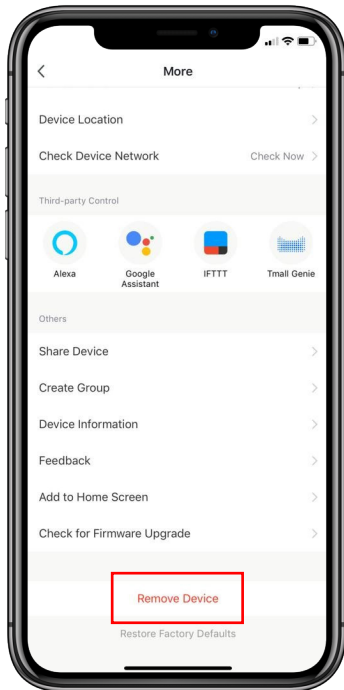

2

Click "**Remove Device**" tab.

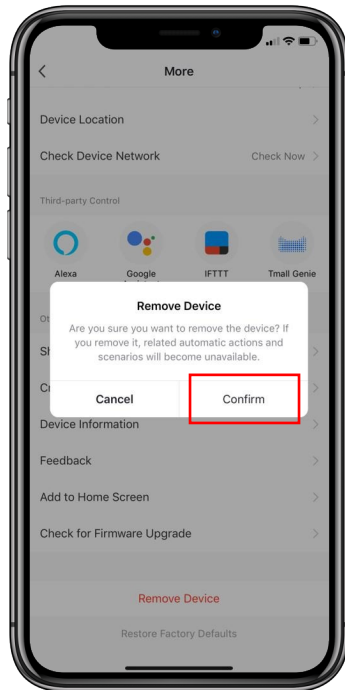

3

Click "**Confirm**" button to completely remove the device from the Legate Smart Home app.

# **Legate Smart LED Light Strip Product Information**

## Product Configuration

---

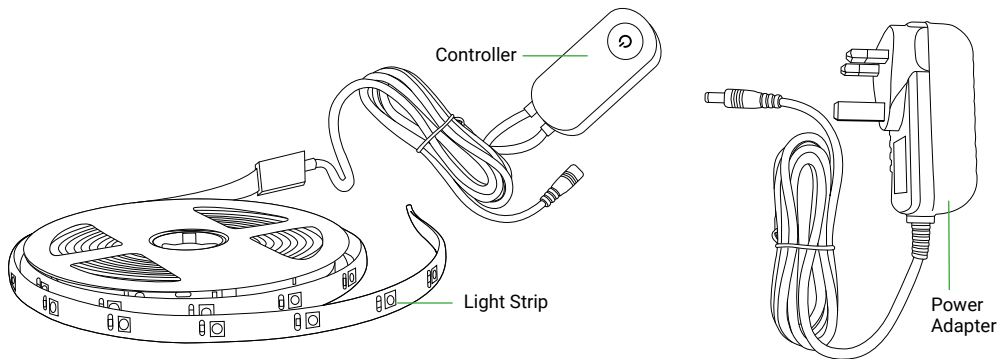

### Factory Reset:

Press and Hold the **⏻ Button** for 5 seconds until the light flashes in red.

\*Note: When the Smart LED Light Strip is connected with new Wi-Fi, you need to restore the factory settings, and re-gain connection.

## Specifications

Model NO.	S50123010-XX	S50123010-XX	S50123010-XX	S50123010-XX
Color	RGB	RGBW	RGB	RGBW
Strip Input	12V --- 2A ⊖ ⊕	12V --- 2A ⊖ ⊕	12V --- 3A ⊖ ⊕	12V --- 4A ⊖ ⊕
Rated Power	12W(LED Strip)	16W(LED Strip)	30W(LED Strip)	40W(LED Strip)

- Lifespan** : About 25000Hr
- Working Temperature** : -20 ~+ 40°C
- Working Humidity** : 0%-85%RH
- Power Input** : 100-240V-50/60Hz 1.5A
- Wireless Connect** : Wi-Fi IEEE 802.11 b/g/n 2.4GHz
- Support systems** : IOS 7.0 or above, Android 4.0 or above
- Free App** : Legate Smart Home

## Safety Precautions

1. Please confirm the working voltage before using this product, the use of inappropriate voltage may cause damage to the product and security risk.
2. LED module can't be replaced, please do not dismantle the product by yourself.
3. The Smart LED Light Strip will generate heat when working. Please see the air circulation for heat dissipation.

## Harmful substances in the product

Parts	Harmful Substances					
	lead (Pb)	mercury (Hg)	cadmium (Cd)	Hexavalent chromium (Cr(VI))	Polybrominated biphenyls (PBB)	Polybrominated diphenyl ethers (PBDE)
Light Strip	○	○	○	○	○	○
Controller	○	○	○	○	○	○
Adapter	×	○	○	○	○	○
Wire	×	○	○	○	○	○
Packing Box	○	○	○	○	○	○

This chart is made in accordance with the provisions of SJ / T 11364.

○ : The content of the hazardous material in all homogeneous materials of the part is within the limit requirement of GB / T26572.

× : The content of the hazardous substance in at least one homogeneous material of the part exceeds the limit requirement of GB / T26572





**LEGATE**<sup>®</sup>  
Smart home

Your one stop shop for all your Smart Home needs

[www.legate.com.sg](http://www.legate.com.sg)